

Instructions for Lincoln Aluminum Straight Rail

36" and 42" Heights



COLOR GUARD
RAILING SYSTEMS

www.colorguardrailing.com

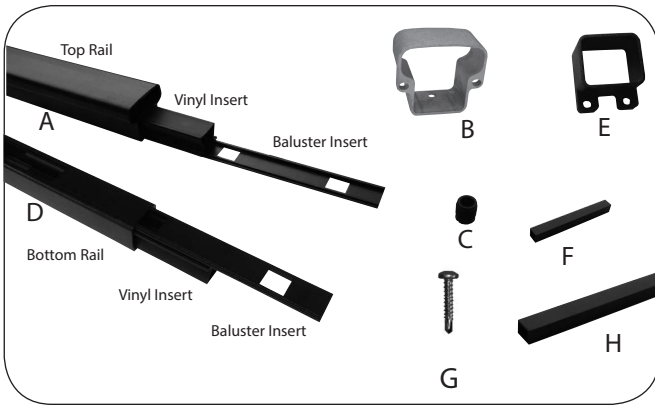

Component List:

- A) Top Rail Assembly with Vinyl & Baluster Insert - 1
- B) Top Rail Bracket - 2
- C) Bottom Brace Plugs - 2
- D) Bottom Rail Assembly with Vinyl & Baluster Insert - 1
- E) Bottom Rail Bracket - 2
- F) Bottom Brace - 1
- G) #10 x 1" Self-Drilling Screws - 12
- H) Balusters -

10 - 4' section	13 - 5' section
15 - 6' section	18 - 7' section
20 - 8' section	26 - 10' section

Tools Required:

- Drill Bits: 5/32"
- #2 square drive hex bit 4" long
- Drill with Adjustable Clutch
- Miter Saw with Metal Cutting Blade
- Level
- Rubber Mallet or Wood Block
- Tape Measure
- 12" Combination Square
- 8" File
- Masking or Duct Tape
- Touch-up Paint - optional
- Center Punch - optional
- Silicone Adhesive - optional
- Shop Vac or blower - optional
- Always wear safety goggles*
- MADE IN THE USA

Installer is responsible for quality workmanship and meeting all building codes.



- Read and understand all instructions before starting your installation.
- Check local building codes.
- Pre-drilling of all holes is recommended.
- Do not over-tighten screws. Set clutch on drill to lowest workable setting.

1

Aluminum Post Installation

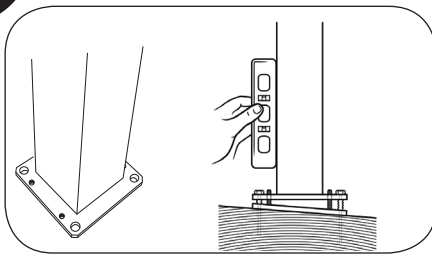

1. Measure and locate all posts.
2. Install posts into frame of deck. Standard deck boards do not provide enough support. Additional blocking may be required for proper post installation. **It is the responsibility of the installer to ensure proper installation, including adherence to all local codes.**
3. Level your posts using the kit provided. Posts must be straight, plumb, and at the same height.
4. Fasteners must be installed in all 4 holes. The posts will accept bolts up to 3/8" diameter. Bolts are not provided. Install collar.

2

Measure & Cut Bottom & Top Rails

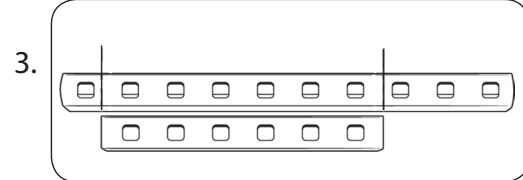
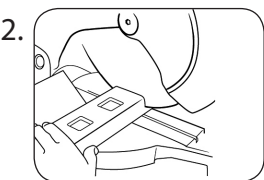
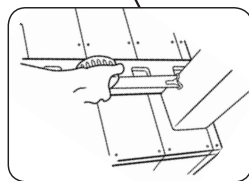
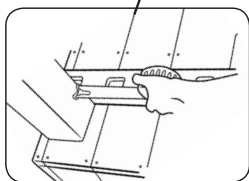
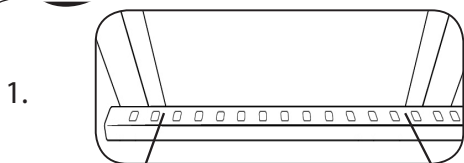

1. Lay bottom rail (D) in front of posts and mark rail for proper cutting on both ends.. Measure from the post to the edge of the first baluster hole. **The distance should be no less than 1 1/4" on both ends.** If you have less than 1 1/4", slide your rail to the left or right to remove a hole. This will allow for balusters to be centered and allow enough room for brackets. In some cases, a longer rail section may be needed to achieve perfect baluster spacing. Put a piece of tape over the baluster rail insert to keep it from moving PRIOR to cutting. Double check your marks before you cut.
2. Slowly cut your bottom rail. To reduce scratching your post, cut in the middle of your mark. This will give you about 1/8" clearance between your post and the rail.
3. Align your bottom rail with your top rail (A), keeping the baluster holes even. Mark your top rail. Place a piece of tape over the baluster rail insert to keep it from moving PRIOR to cutting. Double check your marks before you cut.
4. Cut your top rail. Cut to the outside of your marks.
5. File any sharp edges and remove all metal shavings.

Note: Color Guard touch-up paint is available for purchase.

3 Attach Bottom Brace Plug

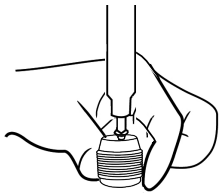

1. Install bottom brace connector (C) to the bottom of the bottom rail using one (1) #10x1 self-drill screw. Rails less than 72" require at least (1) connector, centered. Rails over 72" require (2) connectors evenly spaced. Pre-drill hole with 5/32" drill bit. Cut brace as needed, 2" long.

4 Attach Bottom Rail to Post

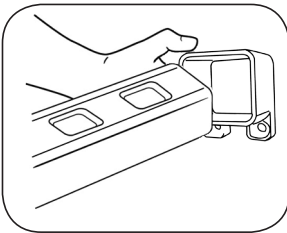

Place rail brackets (E) on ends of bottom rail.

ezTIP: Cut 2 blocks (not included) the same size as the support block. This will support the bottom rail while securing to post.

Attach bracket and rail to post. Apply 2 screws per bracket.

ezTIP: Slightly offset bottom rail (1/16th") to start securing brackets. Screws will angle into bracket and then will center as tightened.

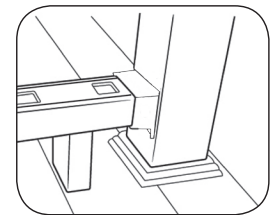

5 Insert Balusters



Insert balusters into bottom rail.

6 Attach Top Rail to Post



Angle balusters away from you. Starting on one end, insert balusters into top rail.

Place brackets (B) on ends of top rail.

Slide rail into position. Screw brackets to post.

Install cap onto post.