

## Truss Base Fan Custom Angle

applications where roof pitch does not match available Truss Base Fan angle  
 applications where roof pitch does not match available Truss Base Fan angle

applications where roof pitch does not match available Truss Base Fan angle (web and rafter angle not perpendicular (90°)); OZCO Butt Joint (#56613) will be utilized (shown with Truss Accent (#56611/51711))

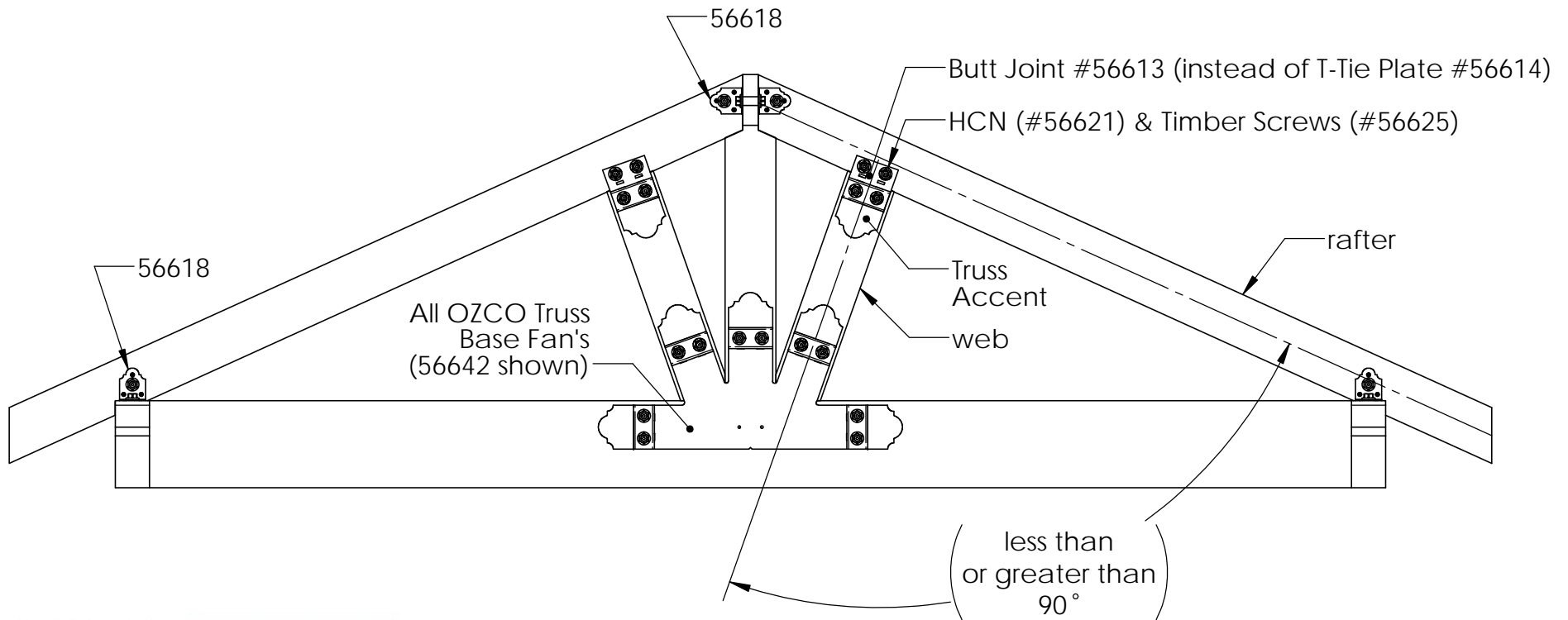

OZCO BUILDING PRODUCTS

Truss Base Fan Custom Angle

Laredo Sunset style shown  
 same procedure for Ironwood